



Stud Pattern and Bearings Specifications

Bawa Trailer Parts

Version 1.0

 07 3277 5349

 bawatrailerparts@gmail.com

 bawatrailerparts.net.au



Stud Pattern Specifications

STUD PATTERN	STUD PCD*	STUD DISTANCE	COMMON STUD SIZE
Ford	5 x 114.3mm	67.18mm	1/2"
HT Holden	5 x 108mm	63.95mm	7/16"
Commodore	5 x 120mm	70.53mm	7/16"
HQ Holden	5 x 120.65mm	70.91mm	7/16"
Landcruiser/Nissan	6 x 139.7mm	69.85mm	1/2"
Landcruiser 100 Series	5 x 150mm	88.20mm	9/16"
Gemini	4 x 100mm	70.71mm	7/16"
Datsun	4 x 114.3mm	80.80mm	7/16"

*Examples of how to measure PCD:

4 stud

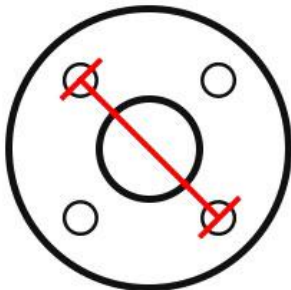

even

5 stud

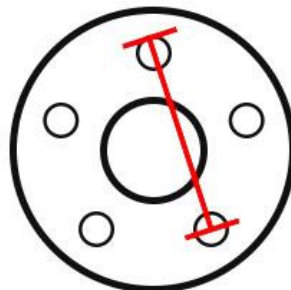

odd

6 stud

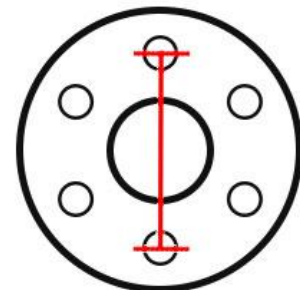

even



Stud Pattern Specifications 1

	Part	Bearing No.	Location	OD	ID	Width
LM	CUP	<i>LM67010</i>	INNER	-	-	-
	CONE	<i>LM60748</i>	INNER	59mm	<i>31.75mm</i>	15.87mm
	CUP	<i>LM11910</i>	OUTER	-	-	-
	CONE	<i>LM11949</i>	OUTER	45.23mm	<i>19.05mm</i>	15.49mm
	SEAL	<i>28560</i>	SEAL	59mm	<i>37.5mm</i>	-

	Part	Bearing No.	Location	OD	ID	Width
S/LINE	CUP	<i>L68110</i>	INNER	-	-	-
	CONE	<i>L68149</i>	INNER	59.13mm	<i>35mm</i>	15.87mm
	CUP	<i>LM12170</i>	OUTER	-	-	-
	CONE	<i>LM12749</i>	OUTER	45.24mm	<i>22mm</i>	15.49mm
	SEAL	<i>28600</i>	SEAL	59mm	<i>43.9mm</i>	-

	Part	Bearing No.	Location	OD	ID	Width
PARALLEL	CUP	<i>L68110</i>	INNER	-	-	-
	CONE	<i>L68149</i>	INNER	59.13mm	<i>35mm</i>	15.87mm
	SEAL	<i>28600</i>	SEAL	59mm	<i>43.9mm</i>	-



Stud Pattern Specifications 2

	Part	Bearing No.	Location	OD	ID	Width
2T	CUP	25520	INNER	-	-	-
	CONE	25580	INNER	82.93mm	<i>44.45mm</i>	23.81mm
	CUP	15245	OUTER	-	-	-
	CONE	15123	OUTER	62mm	<i>31.75mm</i>	18.16mm
	SEAL	33940	SEAL	85.5mm	<i>43.69mm</i>	-

	Part	Bearing No.	Location	OD	ID	Width
USA	CUP	L68111	INNER	-	-	-
	CONE	L68149	INNER	59.97mm	<i>34.99mm</i>	15.87mm
	CUP	L44610	OUTER	-	-	-
	CONE	L44649	OUTER	26.99mm	<i>50.29mm</i>	14.22mm
	SEAL	-	SEAL	59mm	<i>43.69mm</i>	-

**TIP: Having a hard time finding your bearing number? Click and hold the 'ctrl' or 'command' button and the 'f' button to access 'find' mode. Type in your bearing number (for example; L68111) and you'll be directed to the*